

Medical Chat Revolutionizes Healthcare with Advanced AI Chatbot Solutions for Healthcare Professionals

Medical Chat's AI chatbot enhances healthcare with accurate answers, efficient workflows, and personalized patient care, supporting better outcomes.

NEW YORK, NY, UNITED STATES, November 7, 2024 /EINPresswire.com/ -- [Medical Chat](#), a leader in AI-powered healthcare solutions, is changing the landscape for healthcare professionals with its revolutionary AI chatbot. Designed to enhance both accuracy and efficiency, Medical Chat's advanced AI tool empowers healthcare providers to streamline tasks, improve patient interactions, and make data-driven clinical decisions.

In a healthcare environment where precision is paramount, Medical Chat's chatbot supports doctors, nurses, and other medical professionals in managing a range of essential tasks, such as answering medical queries, automating appointment scheduling, assisting with medication management, providing virtual health support, and enhancing data collection and analysis.

Enhancing Clinical Accuracy with Proven [Test Performance](#)

Medical Chat's AI chatbot has undergone rigorous testing on challenging medical exams like the United States Medical Licensing Examination (USMLE) and the MedQA benchmark, where it



Medical Chat Logo

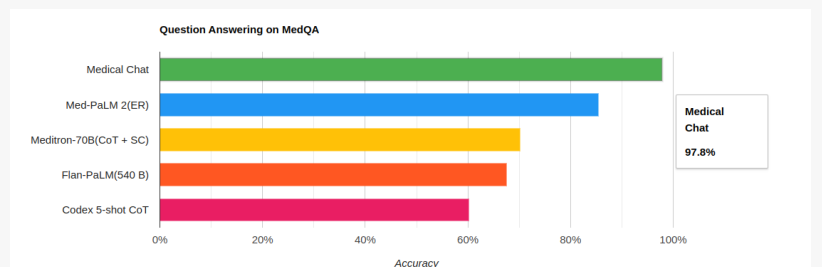

MedQA Medical Chat Performance

achieved a remarkable accuracy rate of 98.1%—outperforming other prominent models. Here’s a look at its results:

USMLE Performance: 97.3% accuracy in Test 1 (183/188), 100% accuracy in Test 2 (218/218), and 97.1% accuracy in Test 3 (236/243), marking it as a top-performing tool in medical question-answering.

MedQA Evaluation: Medical Chat achieved 97.8% accuracy, outscoring Google’s Med-PaLM 2 and other models, confirming its position as the leading AI solution for accurate and reliable medical responses.

This high level of performance positions Medical Chat as an essential resource for healthcare professionals seeking accuracy, reliability, and efficiency in managing patient inquiries and making informed decisions.

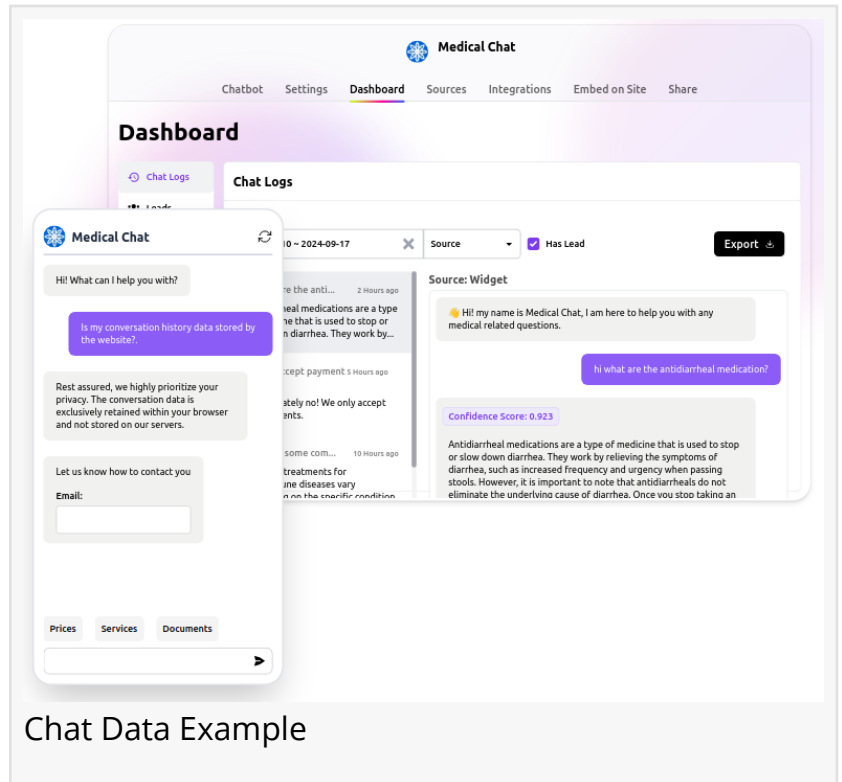

Streamlined Patient Interaction and Enhanced Engagement

One of the key applications of Medical Chat’s chatbot is improving patient interactions, enabling healthcare providers to offer faster, more personalized responses. This efficiency ensures that routine inquiries are handled seamlessly, allowing healthcare professionals to focus on complex cases. The chatbot’s personalized engagement also helps keep patients informed and invested in their treatment plans, improving adherence and satisfaction.

“Medical Chat is reshaping patient communication by facilitating real-time, customized interactions,” said [Insert Name], CEO of Medical Chat. “Our chatbot gives healthcare professionals the ability to connect meaningfully with patients, ultimately enhancing the quality of care.”

Supporting Evidence-Based Decision Making

Medical Chat’s AI solution leverages data to assist healthcare professionals in making evidence-based clinical decisions. By cross-referencing vast medical databases, the chatbot provides accurate diagnostic information and treatment recommendations, minimizing the potential for diagnostic errors. This integration of AI technology into clinical workflows contributes to better patient outcomes and supports providers in delivering high-quality, data-driven care.

Use Cases: Transforming Daily Healthcare Operations

Appointment Scheduling Automation: Medical Chat’s chatbot efficiently manages appointment

bookings, reminders, and cancellations, reducing administrative tasks. Healthcare providers can reallocate their time to more critical aspects of patient care, enhancing overall productivity.

Patient Triage and Prioritization: The AI-powered chatbot plays a significant role in patient triage by assessing symptoms and prioritizing urgent cases. This capability allows healthcare providers to respond more swiftly to critical cases, thereby improving patient response times and outcomes.

Medication Management: The chatbot offers timely medication reminders and alerts to patients, promoting adherence to prescribed treatments. This service reduces the risk of missed doses and supports better health outcomes by ensuring that patients follow their medication schedules consistently.

Reliable Virtual Health Assistance Available 24/7

Medical Chat's AI chatbot is available round-the-clock, providing a 24/7 virtual assistant that responds to patient inquiries, offers health advice, and assists with symptom assessments. This accessibility enhances patient experience and relieves some of the workload on healthcare professionals, ensuring that patients receive immediate support whenever needed.

Data Collection and Analysis for Enhanced Research

Beyond patient interactions, Medical Chat's AI solution also excels in data collection and analysis, gathering valuable insights into patient symptoms, medical history, and treatment responses. This data enables healthcare professionals to identify trends, assess treatment effectiveness, and uncover potential areas for innovation in healthcare.

The information gathered by Medical Chat's AI chatbot contributes not only to the immediate needs of patient care but also supports medical research, aiding in the continuous advancement of healthcare practices.

Future Prospects and Innovations on the Horizon

Medical Chat continues to drive innovation with new advancements, such as integrating the chatbot with wearable technology, offering real-time health data insights, and expanding access to underserved regions. These developments have the potential to bridge healthcare gaps, providing high-quality care to populations that may lack access to immediate medical resources.

Advanced Natural Language Processing (NLP): Through the latest improvements in NLP, Medical Chat's chatbot understands user inquiries more intuitively, facilitating natural conversations that enhance decision-making accuracy.

Global Access: By offering multilingual support and adapting to varied healthcare environments, Medical Chat's AI solution aims to make healthcare accessible globally, regardless of location.

Ethical Considerations and Data Security

Medical Chat is committed to the ethical deployment of AI in healthcare. The chatbot is designed to prioritize patient privacy and data security, adhering to strict confidentiality protocols. With robust encryption measures, Medical Chat ensures that patient data remains secure and accessible only to authorized personnel, reinforcing trust among healthcare providers and patients alike.

Setting a New Standard in AI for Healthcare

With its impressive accuracy on critical exams and evaluations, Medical Chat's AI chatbot sets a new benchmark for AI in healthcare. By providing healthcare professionals with a reliable and efficient tool for medical inquiries, routine task automation, and patient engagement, Medical Chat proves to be an invaluable asset to modern healthcare.

For healthcare providers and institutions seeking to integrate a cutting-edge AI solution, the solution can also be offered in a white labeled way through the [Chat Data](#) platform.

Emma Ke

Chat Data

admin@chat-data.com

Visit us on social media:

[X](#)

[LinkedIn](#)

[YouTube](#)

[Other](#)

This press release can be viewed online at: <https://www.einpresswire.com/article/758477143>

EIN Presswire's priority is source transparency. We do not allow opaque clients, and our editors try to be careful about weeding out false and misleading content. As a user, if you see something we have missed, please do bring it to our attention. Your help is welcome. EIN Presswire, Everyone's Internet News Presswire™, tries to define some of the boundaries that are reasonable in today's world. Please see our Editorial Guidelines for more information.

© 1995-2024 Newsmatics Inc. All Right Reserved.